

**SVBCB** - Brackets Only Kit

**SVBCR8** - Kit With Remote

**SVBCA** - Kit With Alarm

### Supplies in the Kit

#### Brackets Only Kit

- Universal Shaved Door Bracket x2
- 10' of Cable
- 10' of Cable Housing
- Cable Crimps x4
- Heavy Duty Actuator x2

#### Kit With Remote also Includes

- 8 Function Keyless Entry
- 40 Amp Relay x2

#### Kit With Alarm also Includes

- Stellar Alarm w/ BIRT Relay
- 40 Amp Relay x2

## 1. Mount Actuators to the Bracket

Step A

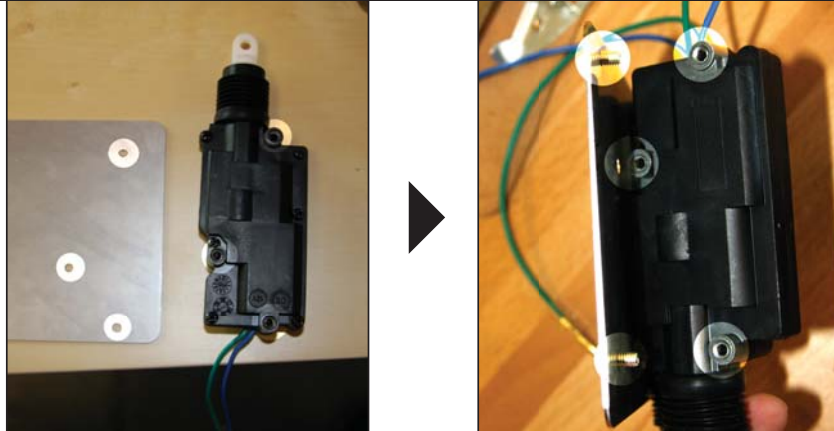

Align the actuator mount screw holes with the actuator's. Secure the actuator to the mount using the 1/4" screws. *\*Special Note* - you might want to pre thread the actuator screw holes before attaching it to the mount for easier installation.

Step B



Do the same with the second actuator.

Step C

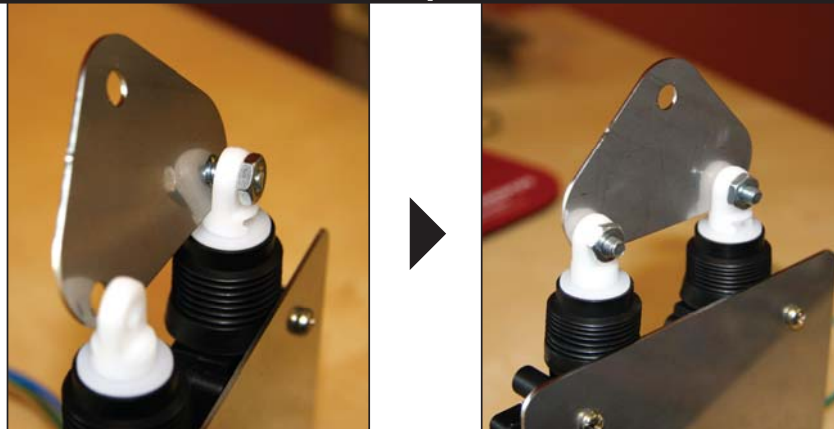

Take the triangle mount and the 1/2" nut & bolt and secure it to the actuators's arm (the white fixture).

Step D

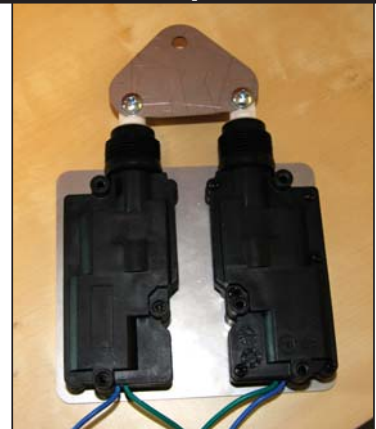

Do the same with the second actuator.

## 2. Mount Actuators to the Vehicle

- a. Remove door's interior door panel and locate the factory latch. Clean and lubricate the latch.
- b. Mount the actuators bracket to a clean piece of metal on the door. Ideally you want to mount the actuators so you have a direct pull from the door latch to the actuators. If you are unable to mount the actuators with a direct pull, relocate the actuators to best fit your door panel. In some cases you will need to use the cable extension kit (SVAEX) to redirect the cable from the latch to the actuators. **(diagram 1)**

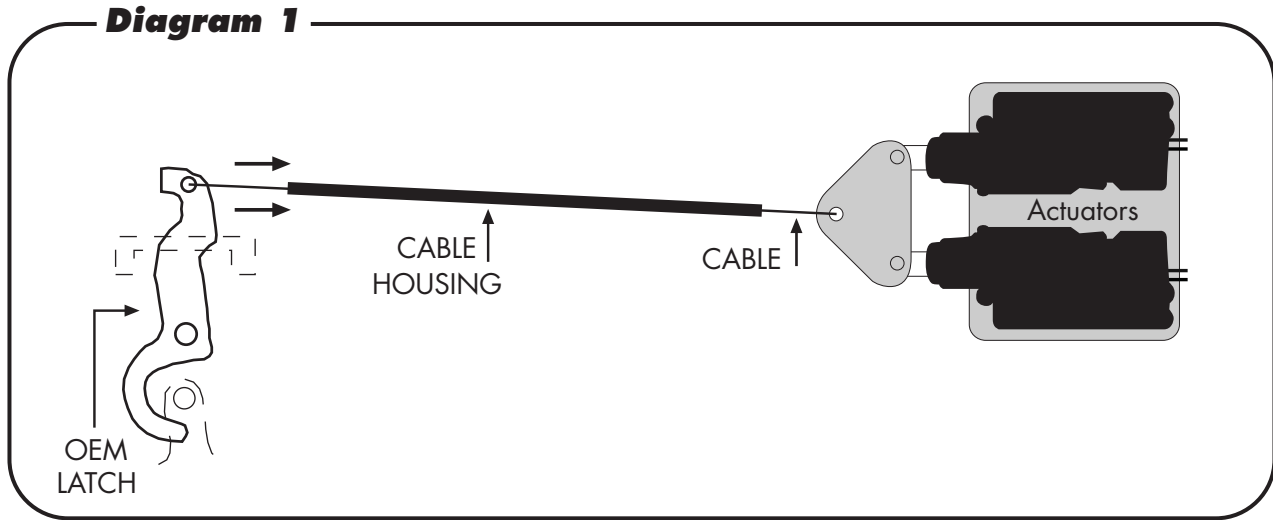

## 3. Install Cable to Door Latch

- a. Create a loop with the cable and secure with the aluminum crimp around the door latch. **(diagram 2)** Run cable through door avoiding all moving parts of the actuators. *\*Cut cable as needed\**
- b. Run the cable through the eye of the actuator, create a loop, and secure with an aluminum crimp. **(diagram 3)** *\*Special Note: For best performance, keep a little slack in the cable.*

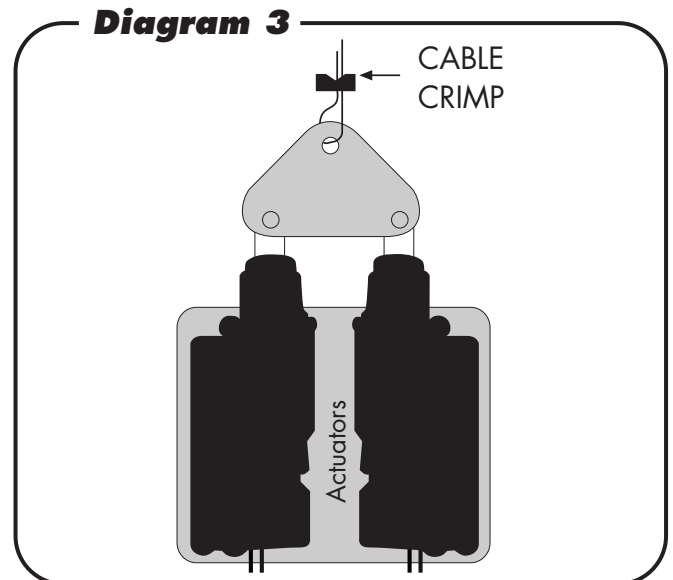
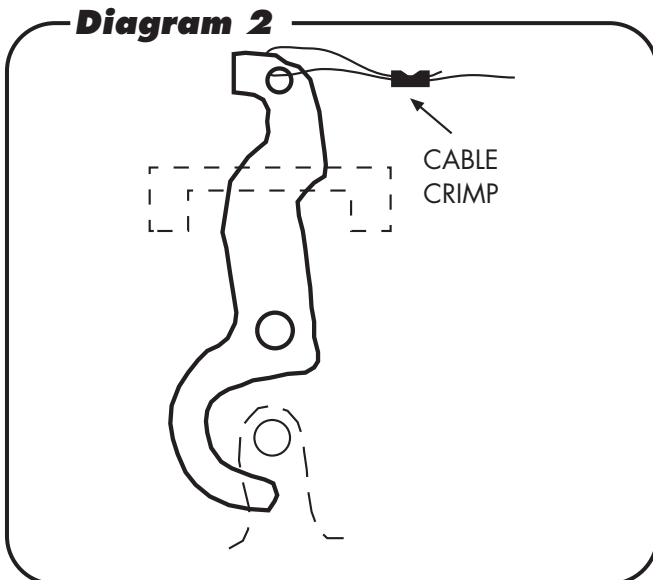

## 4. Wire It Up

- **Wiring Diagram 1 & 2** are for Bracket Only Version
- **Wiring Diagram 3** is for the Kit with Alarm System (SVBCA)
- **Wiring Diagram 4** is for the Kit with Remote (SVBCR8)

**Wiring Diagram 1**

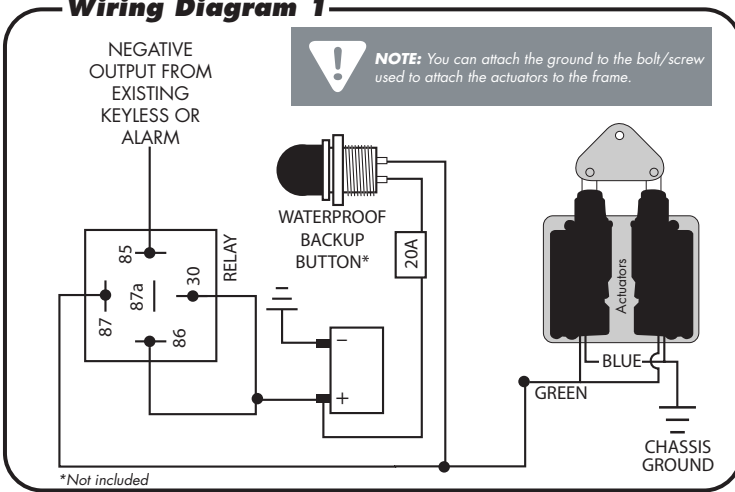

**Wiring Diagram 2**

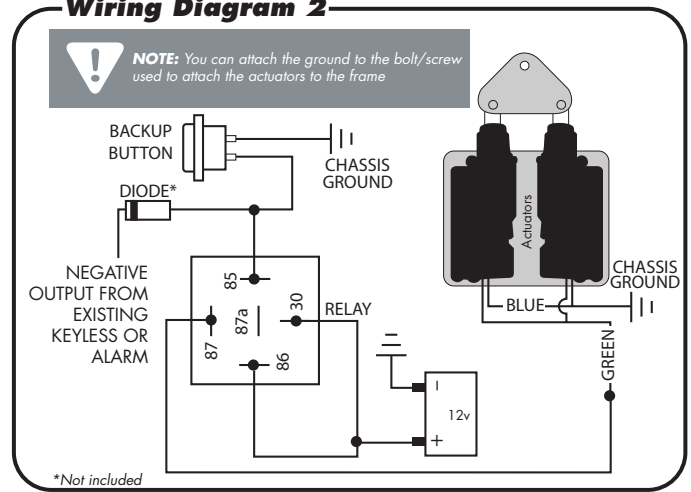

**Wiring Diagram 3**

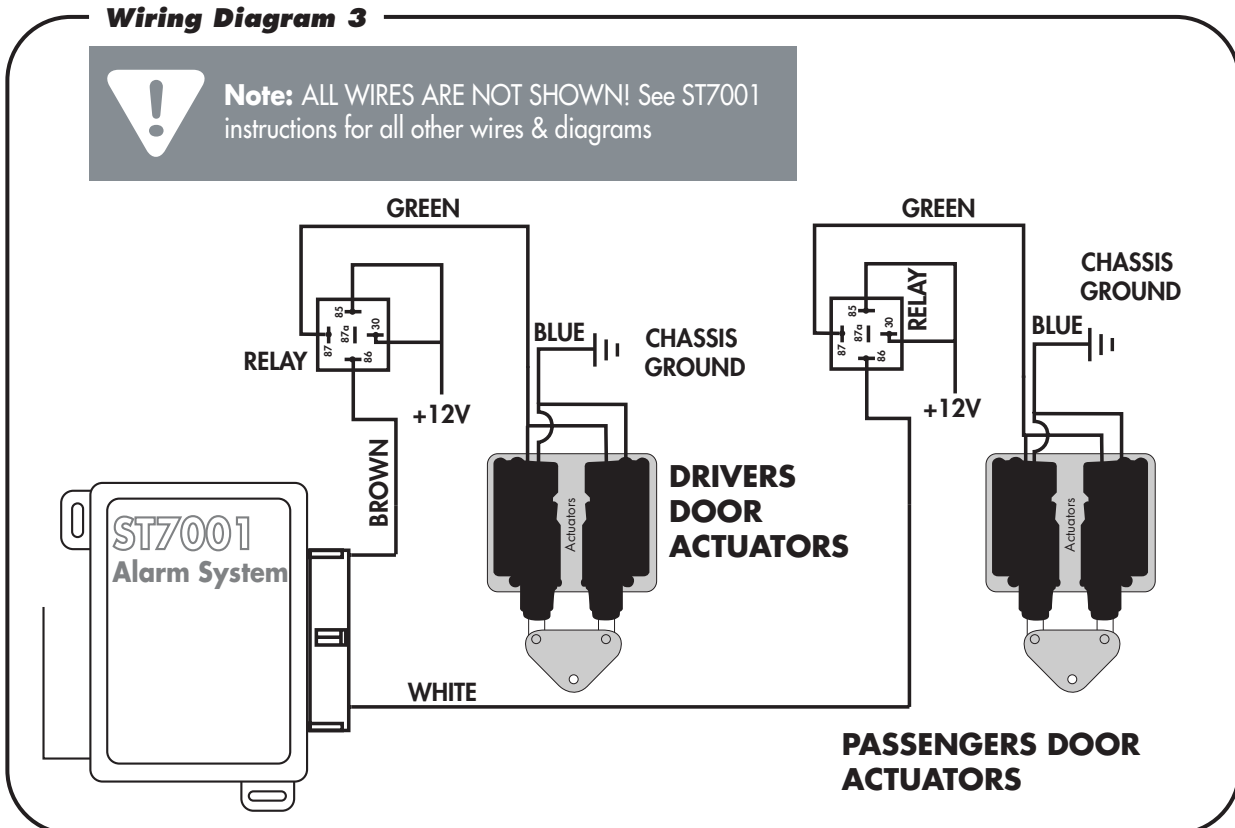

# USER GUIDE AND INSTALLATION MANUAL UNIVERSAL BOLT-ON SHAVED DOOR KIT

## Wiring Diagram 4

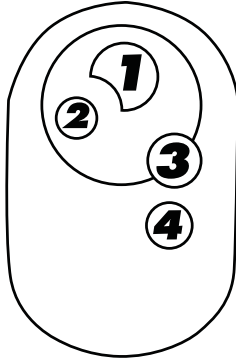

Button	Function	Condition
1	Drivers Door	Anytime
2	Passengers Door	Anytime
3	1st Channel Output	Anytime
4	2nd Channel Output	Anytime
1 + 3	3rd Channel Output	Anytime
2 + 4	4th Channel Output	Anytime
1 + 2	5th Channel Output	Anytime
3 + 4	6th Channel Output	Anytime

